

RHP-15/20/24MS Manual

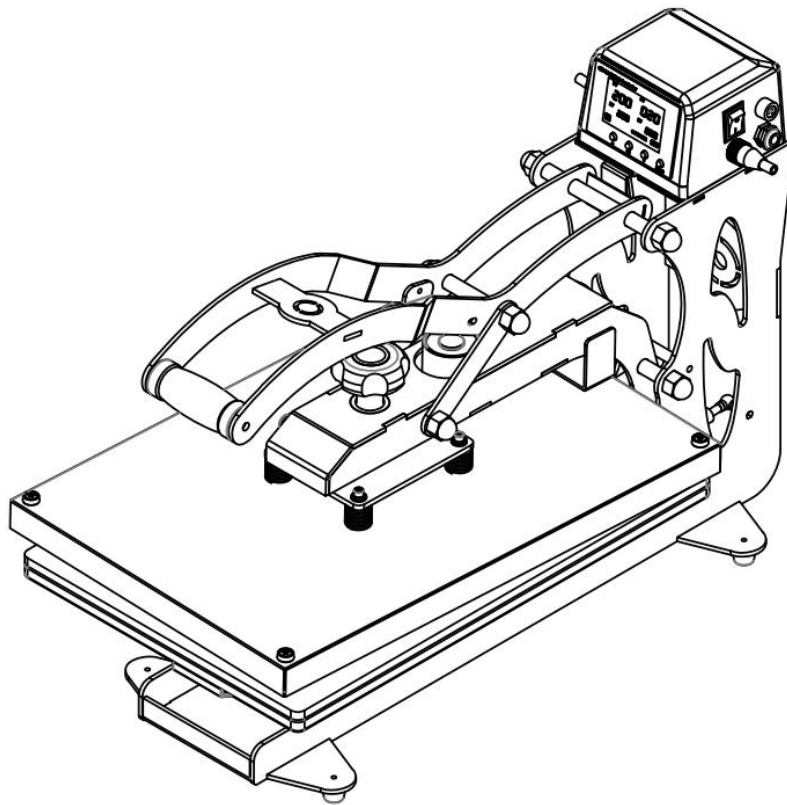

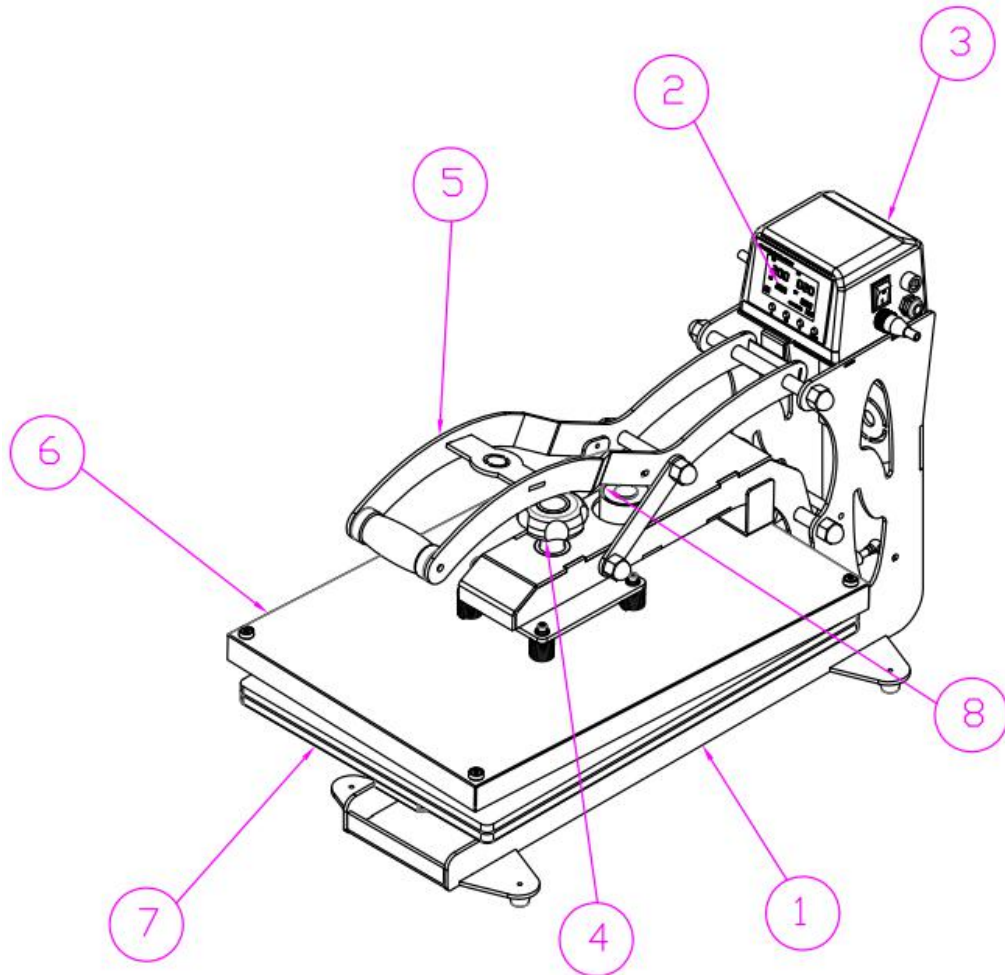

①Rack Components

② GY-06 Temperature Controller

③158 Plastic Electrical Box

④Adjustment Handwheel

⑤Handle Assembly

⑥Heating Plate Assembly

⑦Base Plate Assembly

⑧Electromagnet

GY-06 Operating Manual

1. When you turn on the heat press machine, the display shows as below:

PV (left): Present temperature value

PV (right): Present time value

SV (left): Set temperature value

SV (right): Set time value

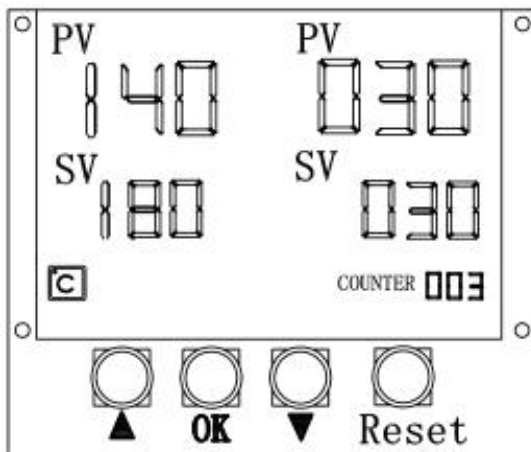

2. Press the "OK" button will shows the degrees Celsius "C". You could use the Up or Down button to switch between degrees Celsius and degrees Fahrenheit.

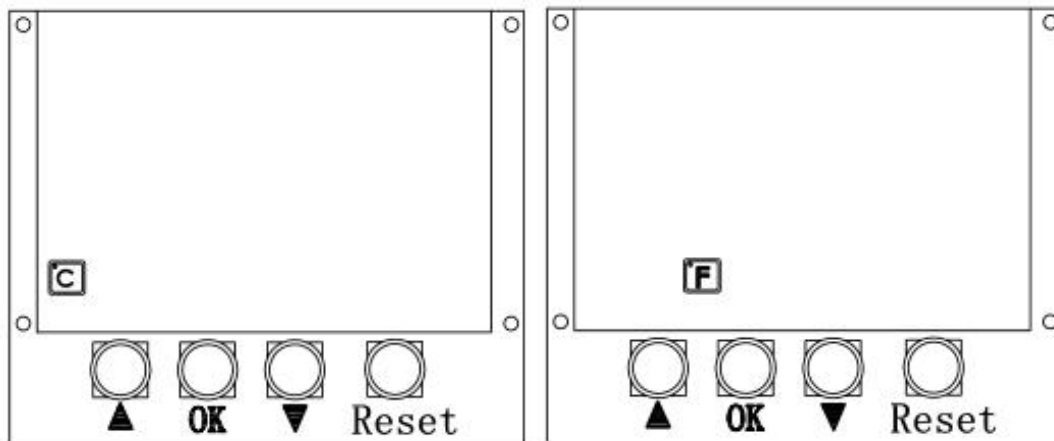

3. Press "OK" button to enter TEMPERATURE setting. When the TEMP indicator SV(left) blinks, use Up/Down button to set the required temperature. (Temperature adjustable range: 0-225 o C/0-437 o F)

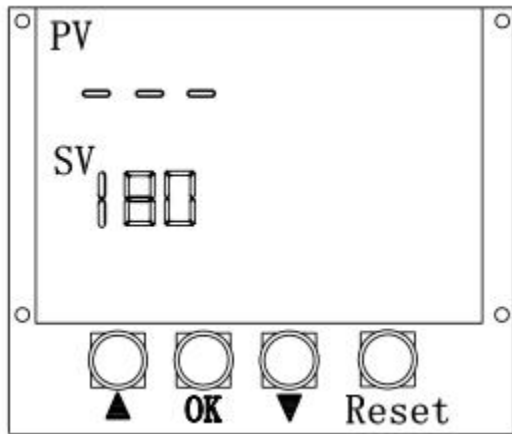

4. Press “OK” button to enter TIME setting. When the TIME indicator SV(right) blinks, use Up/Down button to set the required time. (Time adjustable range: 0-999S)

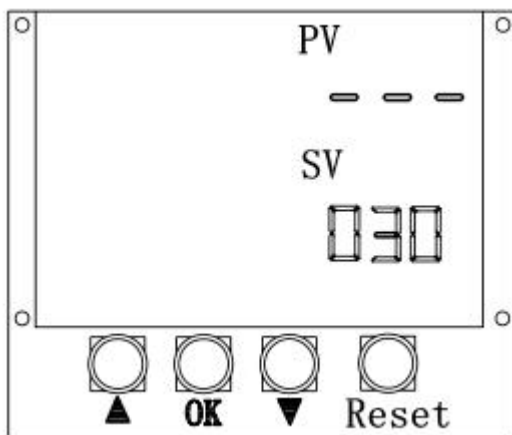

5. After finishing above-mentioned settings, press “OK” button to enter the heating mode.
6. If you need to adjust the settings during the heating mode, you could repeat step 2 to step 5 to do the adjustment.
7. Long press “Reset” button for 3 to 5 seconds, the COUNTER value will blink, then clear to “0”.
8. Press down the heating platen to start, the time will begin to count down. When the time is left to 3 seconds, the buzzer will warn. When the time is over, the transfer process is complete.
9. Long press “OK” button for 4 to 5 seconds, the controller will enter the engineering mode:
P-1 mode: Temperature difference calibration mode (range-50~+50)
P-2 mode: Intermittent setting in advance mode (range01~50)

Pb mode: Countdown of buzzer sound mode

1: After the time reaches 0, it starts to beep and keeps beeping until you open the machine. Please set Pb

as 02.

2: Start to beep 3 seconds ahead of schedule and keep on beeping until you open the machine. Please set Pb as 01.

3: No sound. Please set Pb as 00.

Cnt mode: display Odometer, a counter that increments whenever the count-down timer is started. After 65535999 is counted, Cnt flashes; it cannot be cleared to 0.

Ant mode: display hourson, keep track of the number of hours that the heat press has been turned on. After 65535h 999m, Ant flashes; it cannot be cleared to 0.

After finishing above-mentioned settings, press "OK" button to enter the display.

Kindly note: for the engineering mode adjustment, please under supplier's guidance.

Maintenance

1. In order to prolong the machine service life, please add the lubrication oil on the joints regularly .
2. Turn off the power before changing spare parts. In order to ensure the accuracy of the parameter of GY-04 controller. please re-set the time and temperature.
3. To avoid damage, please keep the heaters well when change the spare parts.

Trouble Shooting For Transfer Print Quality

1. After changing heat platen, time and temperature showing become abnormal: Solution: Reset time/temperature according to the manual.
2. If the color is not as bright as photo after printing, please try below ways: Solution: A. Adding transfer time. B. Increasing transfer temperature.
3. If the print color is too brown or the transfer paper is almost burnt: Solution: Please reduce the setting temperature.
4. If print color is different/ partial transfer effect is not good enough: Solution: A. Increase the pressure. B. Extend the transfer time. C. Change the sublimation paper.
5. If the machine is getting abnormal, please contact us to solve the problems

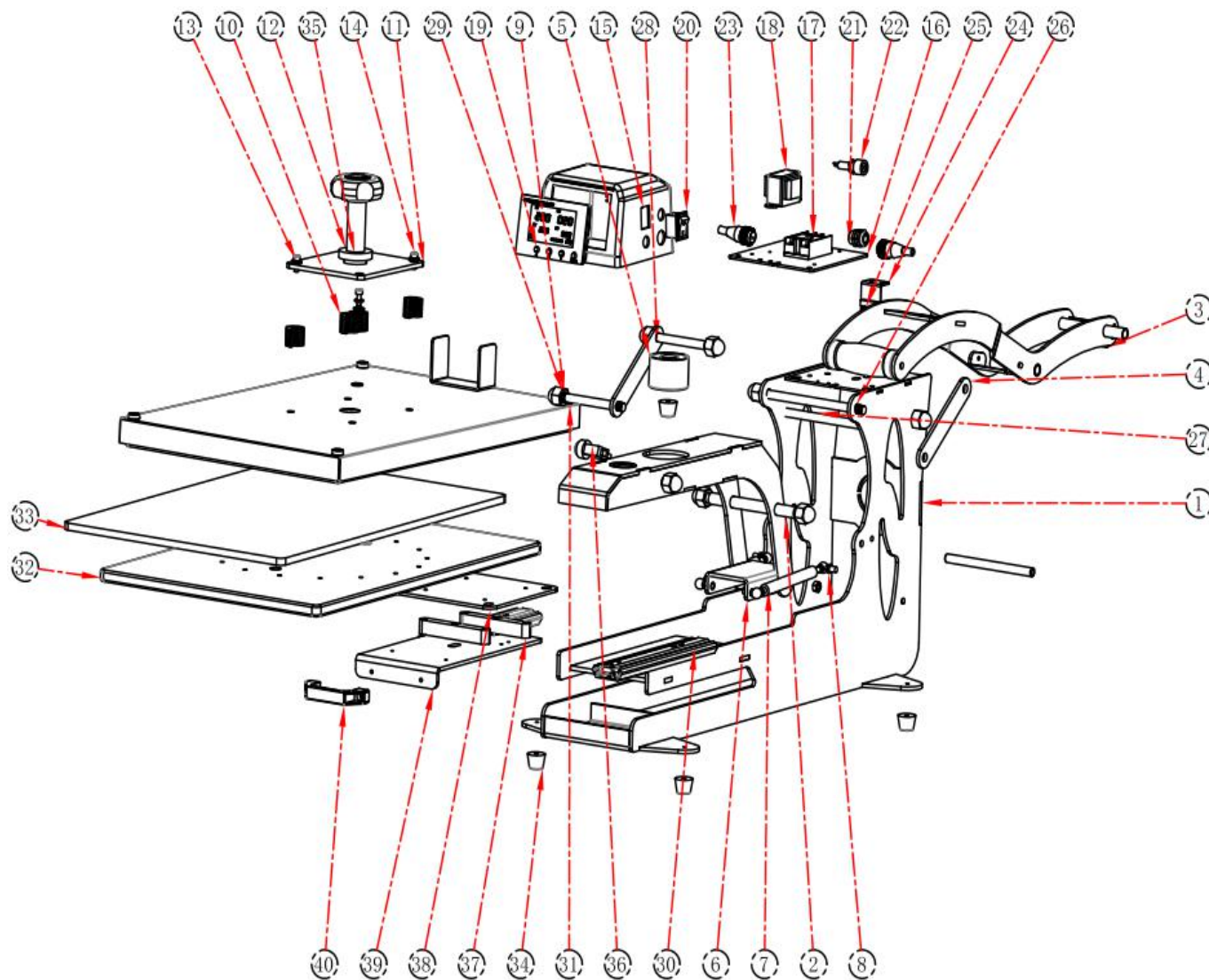

No.	Part Number	Quantity
1	MAX-158A rack	1
2	158A - Boom A	1
3	Assembly 4-158A	2
4	Connecting piece-158A	1
5	Electromagnet 1-158A	1
6	Air pressure spring connecting plate-158A	2
7	Air pressure spring assembly-	2
8	Air pressure spring 2-158A	8
9	GB_SPECIAL_TYPE18 M16-N	4
10	Heating leaf spring-158A	1
11	Adapter board-158A	5
12	GB_FASTENER_WASHER_SM WC 8	4
13	GB_FASTENER_WASHER_SW	4
14	GB_FASTENER_SCREWS_HSH CS_M6X16-N	1
15	MP158AP electrical box	1
16	158A electrical box base	1
17	solid state relay	1
18	Latest certified transformer	1
19	GY06 temperature control meter	1
20	boat switch	1
21	Electric cable connector	1
22	Circuit breaker-insurance	1
23	power cable	1
24	Door magnetic switch-158A	1
25	door sensor switch	1
26	Handle shaft-195	1
27	Handle shaft-156	2
28	max handle shaft-160	1
29	Handle shaft-125	1
30	Slide rail assembly 24-10A	2
31	400-600 heating plate assembly A	1
32	Die-cast base plate 40-60	1
33	400x600 silicone pad	1
34	Tapered machine feet	5
35	Handwheel 3-158A	1
36	red hat stop switch	1
37	Base plate mounting plate connector-158A	2
38	Baseboard adapter board-158A	1
39	MAX pull-out bottom plate A	1
40	Small handle-90	1

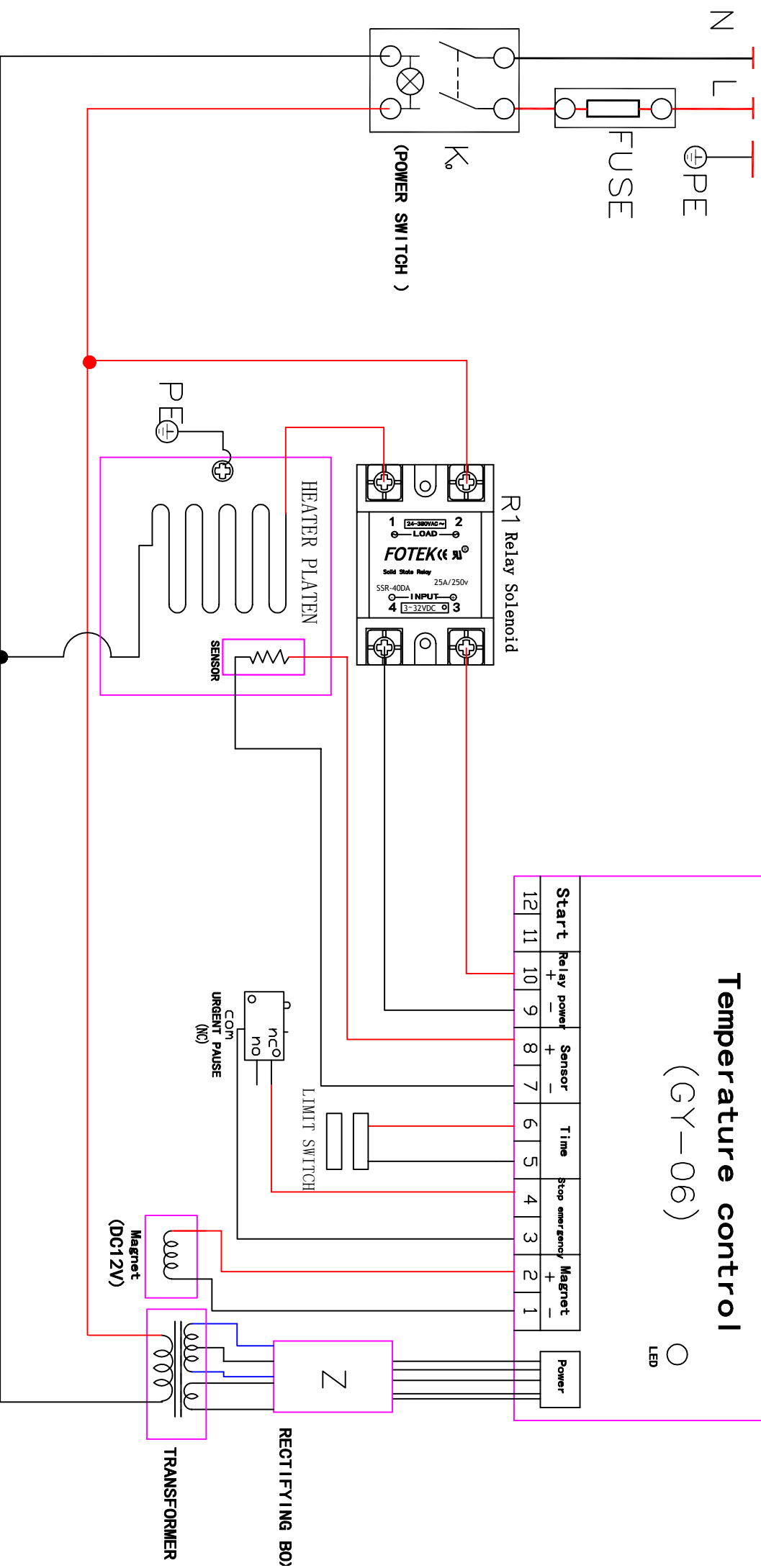

Temperature control

(GY-06)

12	11	10	9	8	7	6	5	4	3	2	1
Start	Relay power	Sensor	Time	Stop emergency	Magnet						
	+	+			+						
	-	-			-						

○ LED

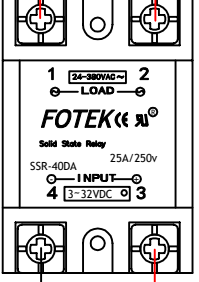

R1 Relay Solenoid

HEATER PLATEN

SENSOR

PE

COM
URGENT PAUSE
(NO)

LIMIT SWITCH

Magnet
(DC12V)

Z

RECTIFYING BOX

TRANSFORMER

FUSE

K0

(POWER SWITCH)

N L PE