

# Mini Cap Heat Press Manual

Model No.: PP-10C

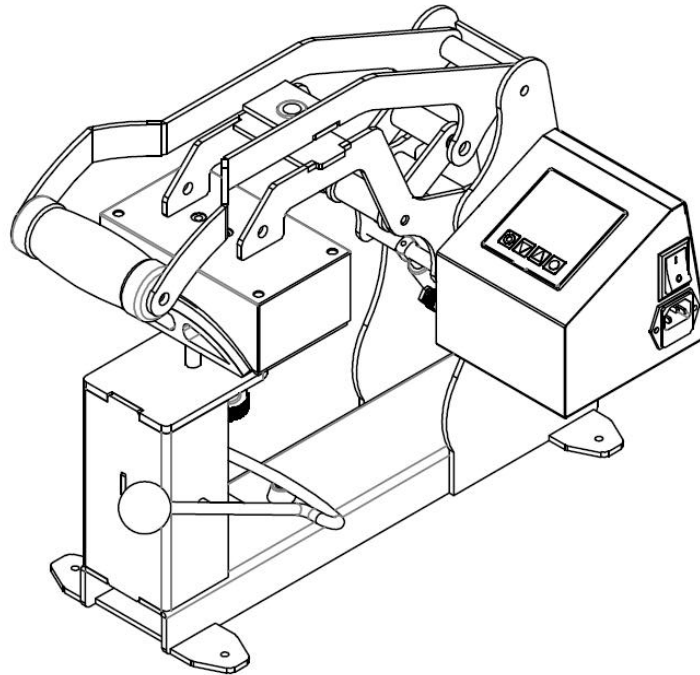

I. Assembly Drawing	-----	2-3
II. Technical Parameters	-----	4
III. Maintenance	-----	5
IV. Trouble Shooting For Transfer Print Quality	-----	5
V. Circuit Diagram	-----	6

## I. Assembly Drawing

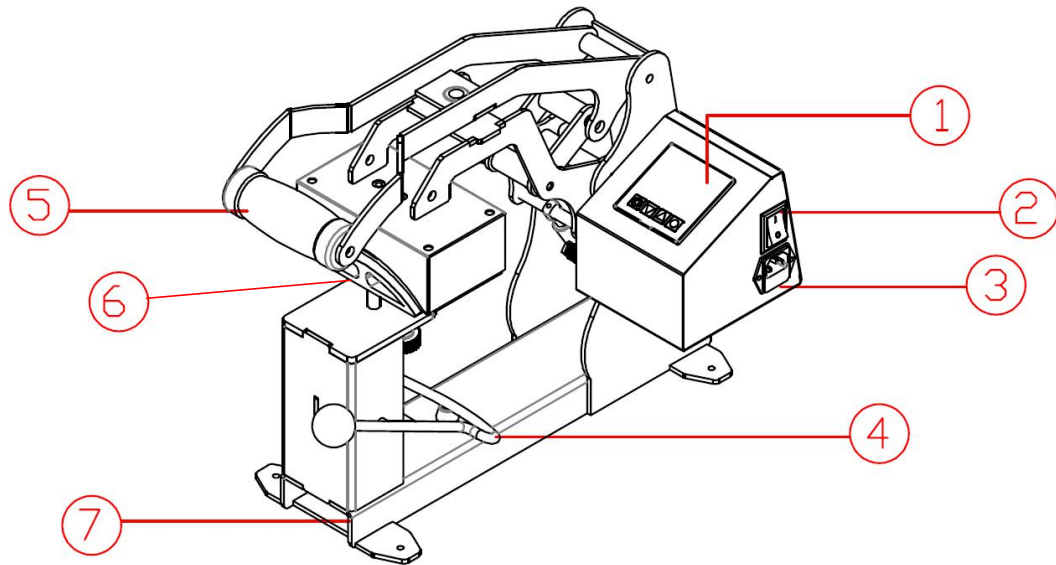

①	GY-10 Digital Controller	②	Rocker Switch
③	Power Socket	④	Cap Fixer
⑤	Handle	⑥	Cap Heater and Base
⑦	Machine Frame		

## II. Technical Parameters

Heater Size: 14.5\*8cm Cap Heater + Cap Base

Controller: GY10 Digital Time & Temp. Control

Under Plate: Exchangeable

Gas Spring: 20kg\  $\varnothing$  15\164MM\*1pc

Opening Angle: 45 degrees

Voltage: 120V/ 220V

Time heating to 200°C: around 5min

Power: 350W

Time Range: 0-999 sec.

Temp Range: 0-225 C

Temperature Accuracy:  $\pm 5$  C

Machine Size: 448\*257\*365mm

Packing Size: 57x37x47cm

Net Weight: 11KG

Gross Weight: 12.7KG

## III.Maintenance

1. In order to prolong the machine service life, please add the lubrication oil on the joints regularly .
2. Turn off the power before changing spare parts. In order to ensure the accuracy of the parameter of GY-10 controller, please re-set the time and temperature.
3. To avoid damage, please keep the heaters well when change the spare parts.

## IV.Trouble shooting for transfer print quality

1. After changing mug heater, time and temperature showing become abnormal:  
Solution: Reset time/temperature according to the manual
2. If the color is not as bright as photo after printing, please try below ways:  
Solution: A. Adding transfer time. B. Increasing transfer temperature.
3. If the print color is too brown or the transfer paper is almost burnt:  
Solution: Please reduce the setting temperature.
4. If print color is different/ partial transfer effect is not good enough:  
Solution: A. Increase the pressure. B. Extend the transfer time. C. Change the sublimation paper.
5. If the machine is getting abnormal, please contact us to solve the problems.

## V. Circuit Diagram

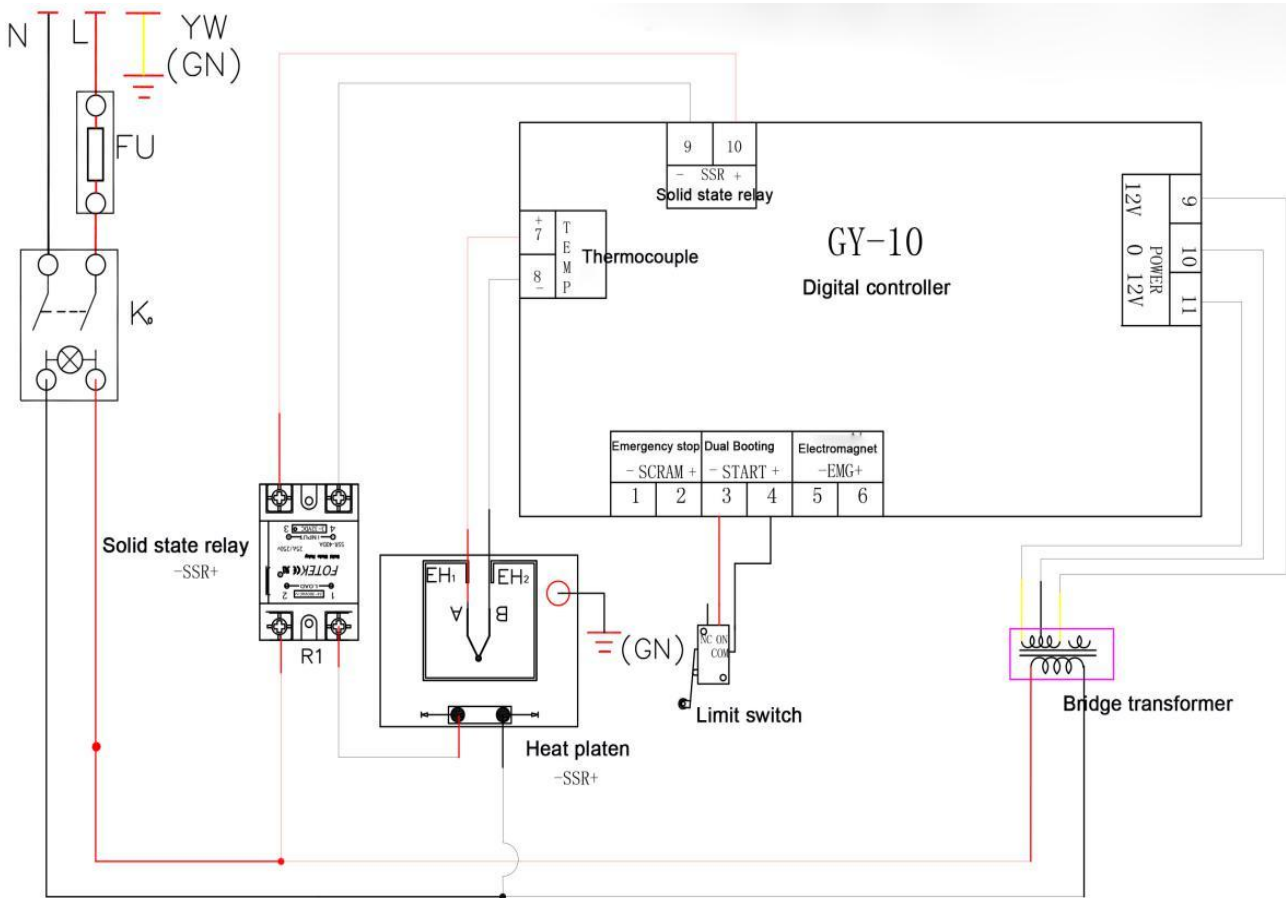

## VI. Exploded view

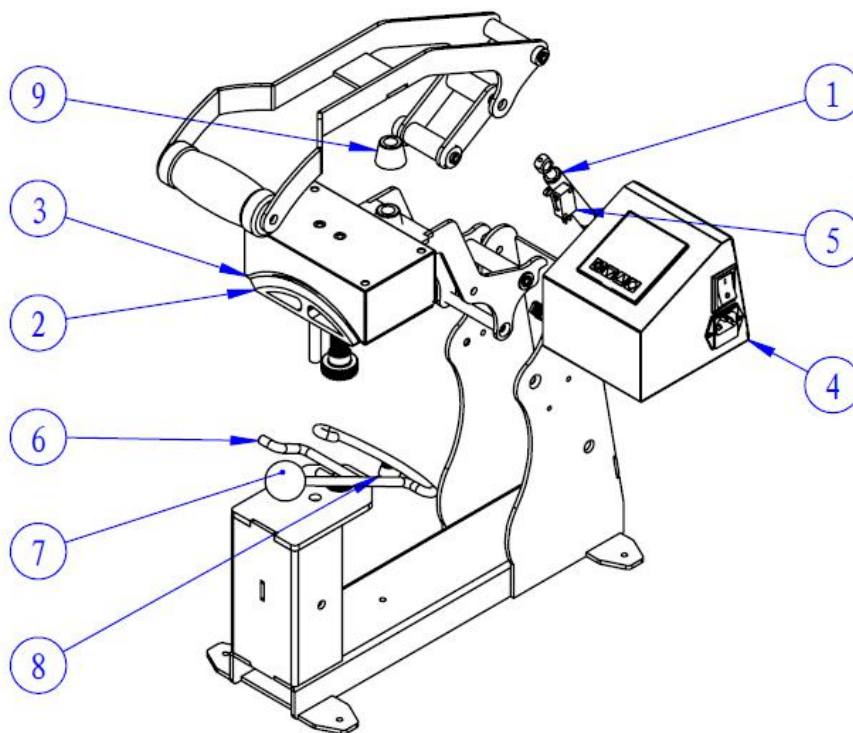

1	Gas Spring
2	Cap Base
3	Cap Heater
4	Housing
5	Limit Switch
6	Cap Fixer
7	Pressure Adjust Knob
8	Machine Feet
9	Conic Machine Feet