

OTO-24 Flatbed Continuous Transfer Printing Machine

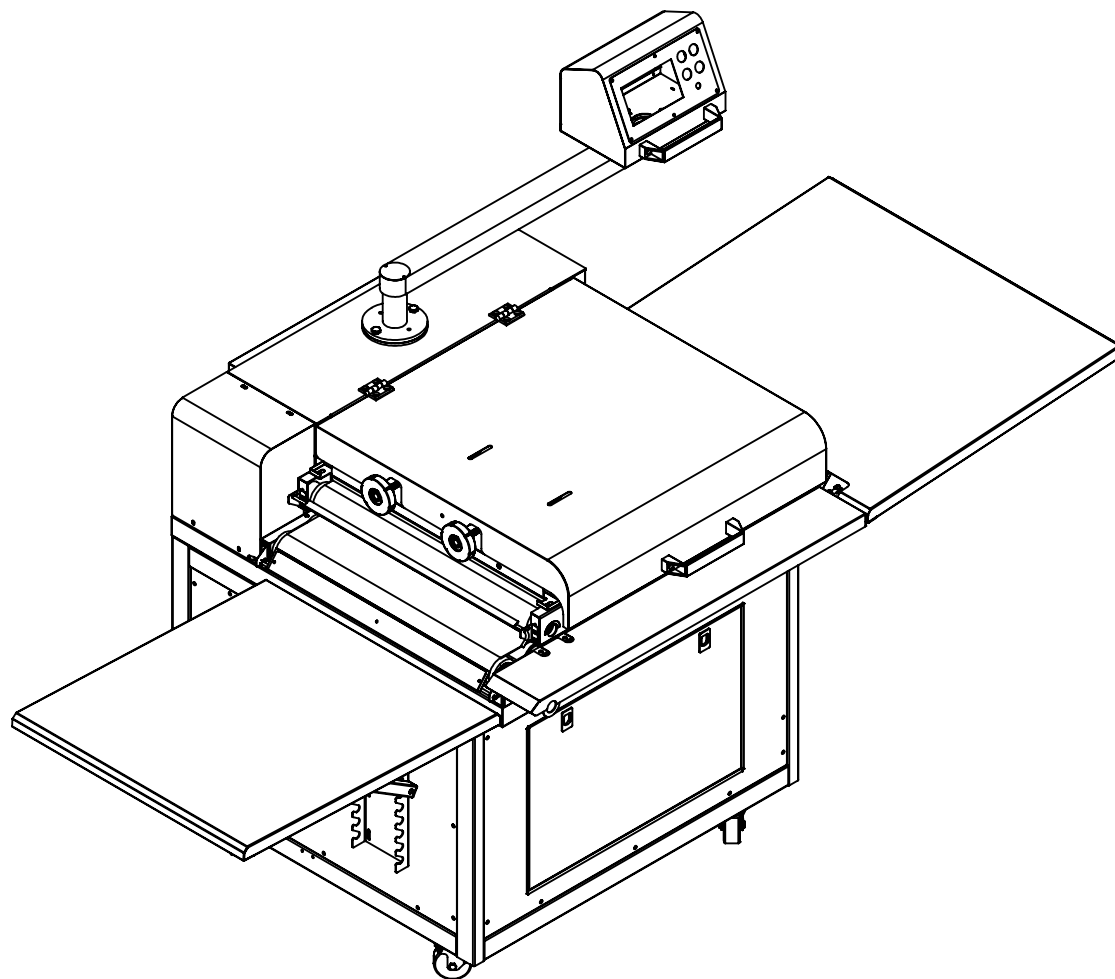

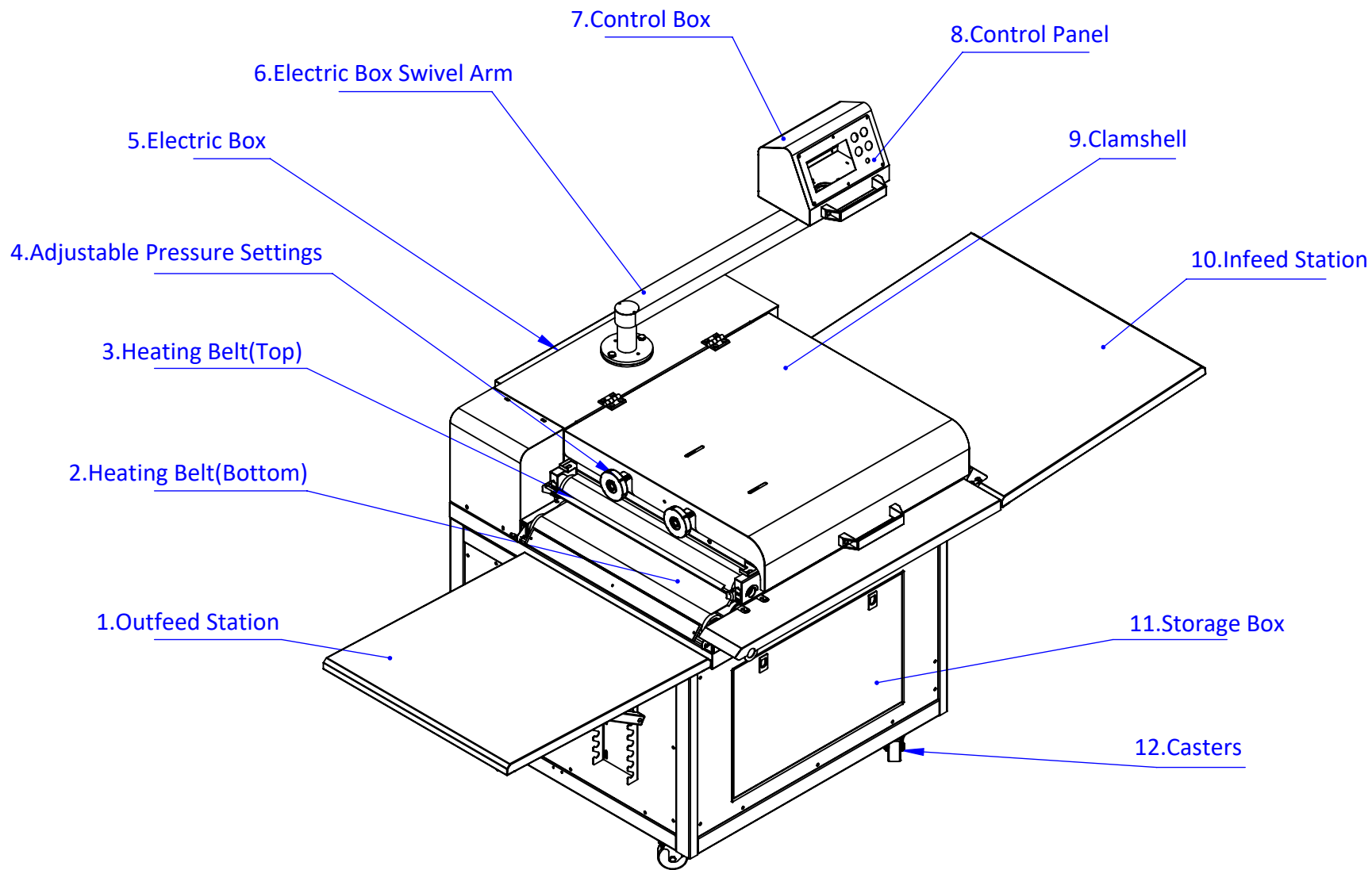

- | | | | |
|--------------------|----------------------------|----------------------|---------------------------------|
| 1. Outfeed Station | 2. Heating Belt(Bottom) | 3. Heating Belt(Top) | 4. Adjustable Pressure Settings |
| 5. Electric Box | 6. Electric Box Swivel Arm | 7. Control Box | 8. Control Panel |
| 9. Clamshell | 10. Infeed Station | 11. Storage Box | 12. Casters |

OTO-24 Instructions Manual

1) Turn off the main power switch, connect the power cord to the machine, turn on the main switch, and the red power indicator light will be on.

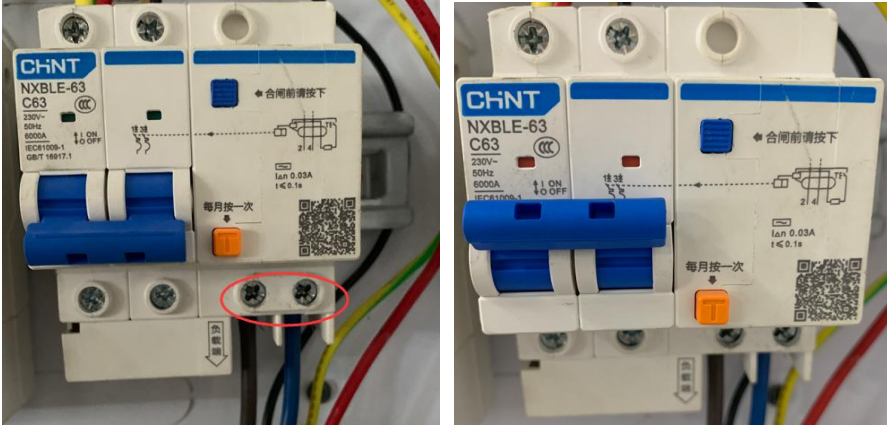

2) Press the power switch button, the machine is powered on, the motor starts and the conveyor belt rotates;

2 controllers are displayed, press the SET button respectively, the SV font flashes, press the up and down arrows to adjust the value, press the left arrow to switch the ones/tens/hundreds, press the SET button to save and exit after the setting is completed. (Celsius adjustable range 0~200° C)



3) Adjust the motor speed control knob to 3 and set the temperatures of top and bottom plate to 165°C, then the temperature rises to the set temperature to start the transfer.

4) After the transfer is completed, press the power switch again to shut down the machine, the green shutdown indicator and the red power indicator are on at the same time, and the controller is off. The motor continues to rotate until the temperature drops to about 90°C, the green indicator light goes out and the motor stops automatically.



PS: Press emergency stop in case of abnormality during the transfer process, the motor stops. When shutting down, the green indicator light is on, please do not cut off the main power supply to avoid scalding the conveyor belt.



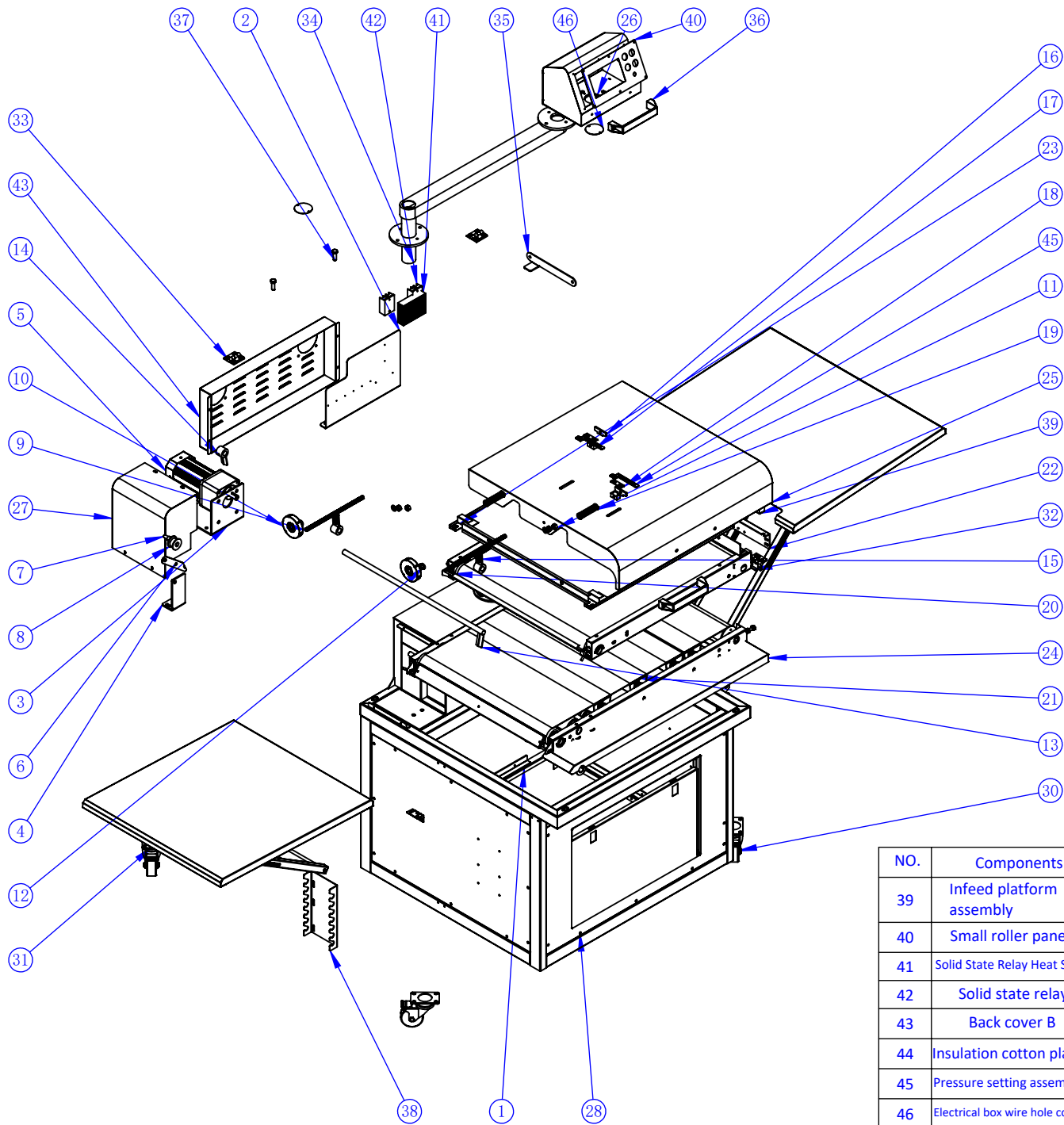



NO.	Components	Materials	QTY
1	Sealed Weld Assembly	A3	1
2	Electrical mounting plate	A3 board	1
3	Motor mounting plate	A3 board	1
4	Tension base	A3 board	1
5	200W speed control motor 40K		1
6	Tension base 2	A3 board	1
7	Tension shaft	Round steel	1
8	Tension wheel	Nylon 6/10	1
9	M10 screw	A3 board	2
10	Handwheel 1146	Bakelite	2
13	Adjustment rod assembly	A3	1
14	Adjustment tab assembly 2	A3	1
15	Adjustment tab assembly 3	A3	2
16	Regulating sheet 3	A3 board	2
17	Regulating sheet 4	A3 board	2
18	Regulating sheet 5	A3 board	2
19	Spring	A3 board	2
20	Top heating element	A3	1
21	Bottom heating element	A3	1
22	Infeed baffle assembly	A3	1
23	Anti-scald cover	A3	1
24	Front fender assembly	A3	1
25	Top cover assembly	A3	1
26	Welded body for small drum electric box	A3	1
27	Side cover welding	A3	1
28	Door 1	A3 board	1
29	Buckle lock	Plastic	2
30	CKRR02-D75 casters		4
31	Outfeed platform assembly	A3	1
32	Outfeed bracket weldment	A3	2
33	50 Hinge		6
34	Electric Box Swivel Rod Assembly	A3	1
35	Flip support 4	A3 board	1
36	Big handle		2
38	Spacer positioning 2	A3 board	2

NO.	Components	Materials	QTY
39	Infeed platform assembly	A3	1
40	Small roller panel	A3 board	1
41	Solid State Relay Heat Sink	/	1
42	Solid state relay	/	2
43	Back cover B	A3 board	1
44	Insulation cotton plate	A3 board	1
45	Pressure setting assembly	A3	2
46	Electrical box wire hole cover	A3 board	2

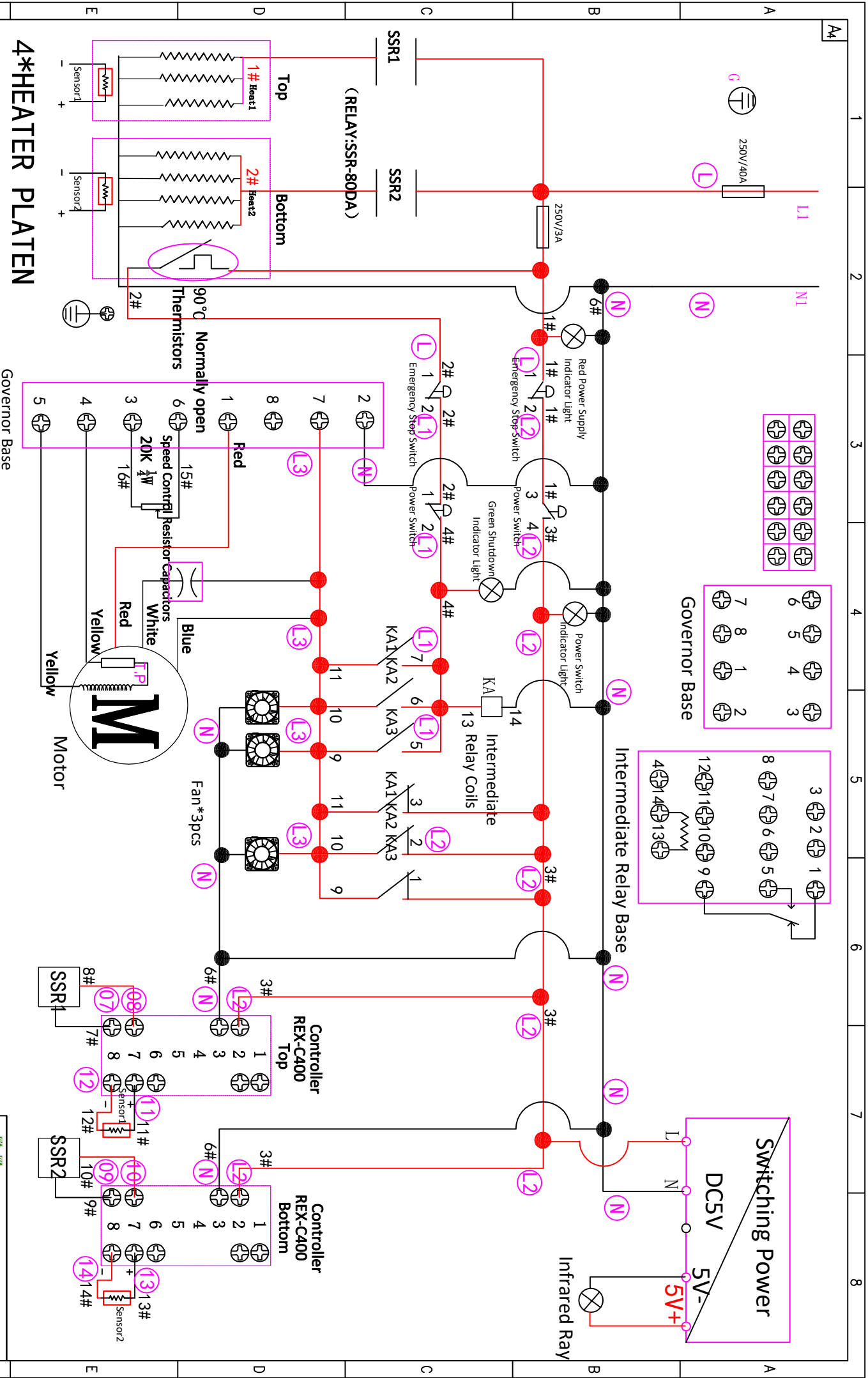
4*HEATER PLATEN



东莞国扬数字科技有限公司
 MICROTEC
 MICROTEC PRINTER CONSUMABLE CO., LTD

产品编号: 0T0-24
 产品类型: 连续滚筒机
 产品名称: 连续滚筒机
 日期: 2023-7-1