

Instruction Manual of Microtec MT-201

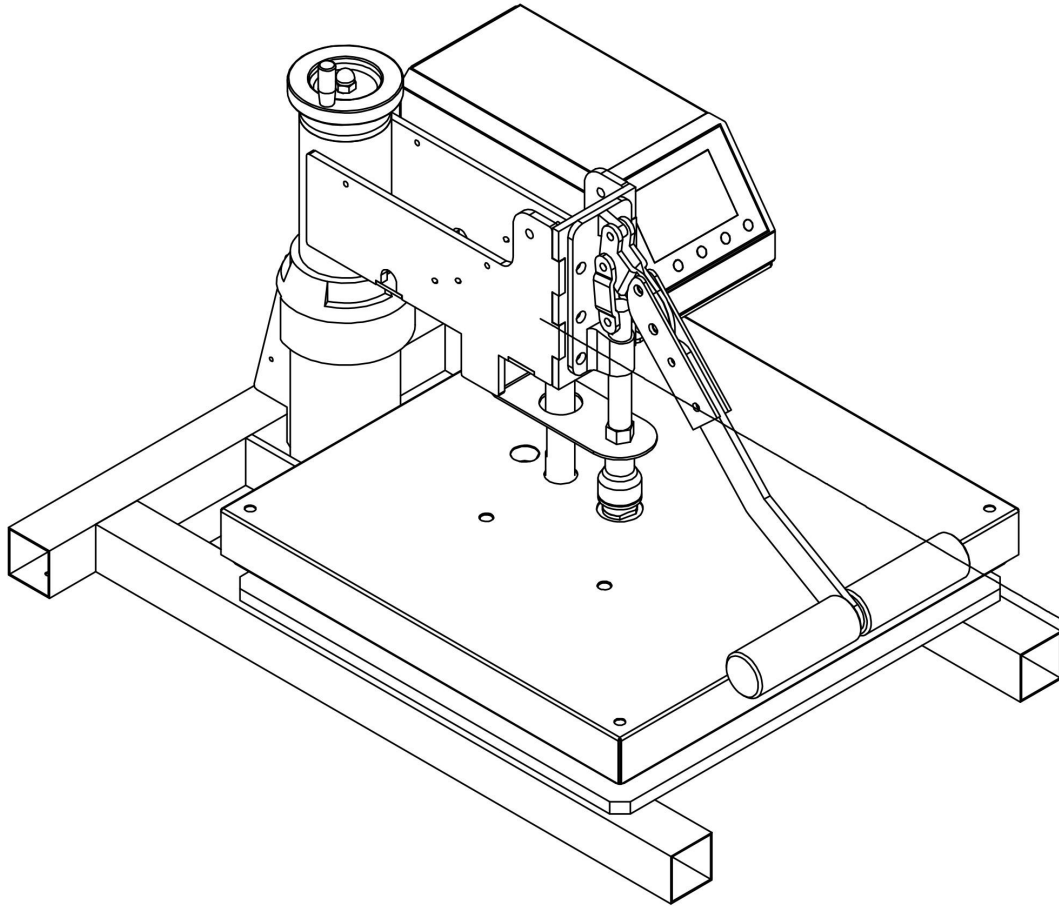

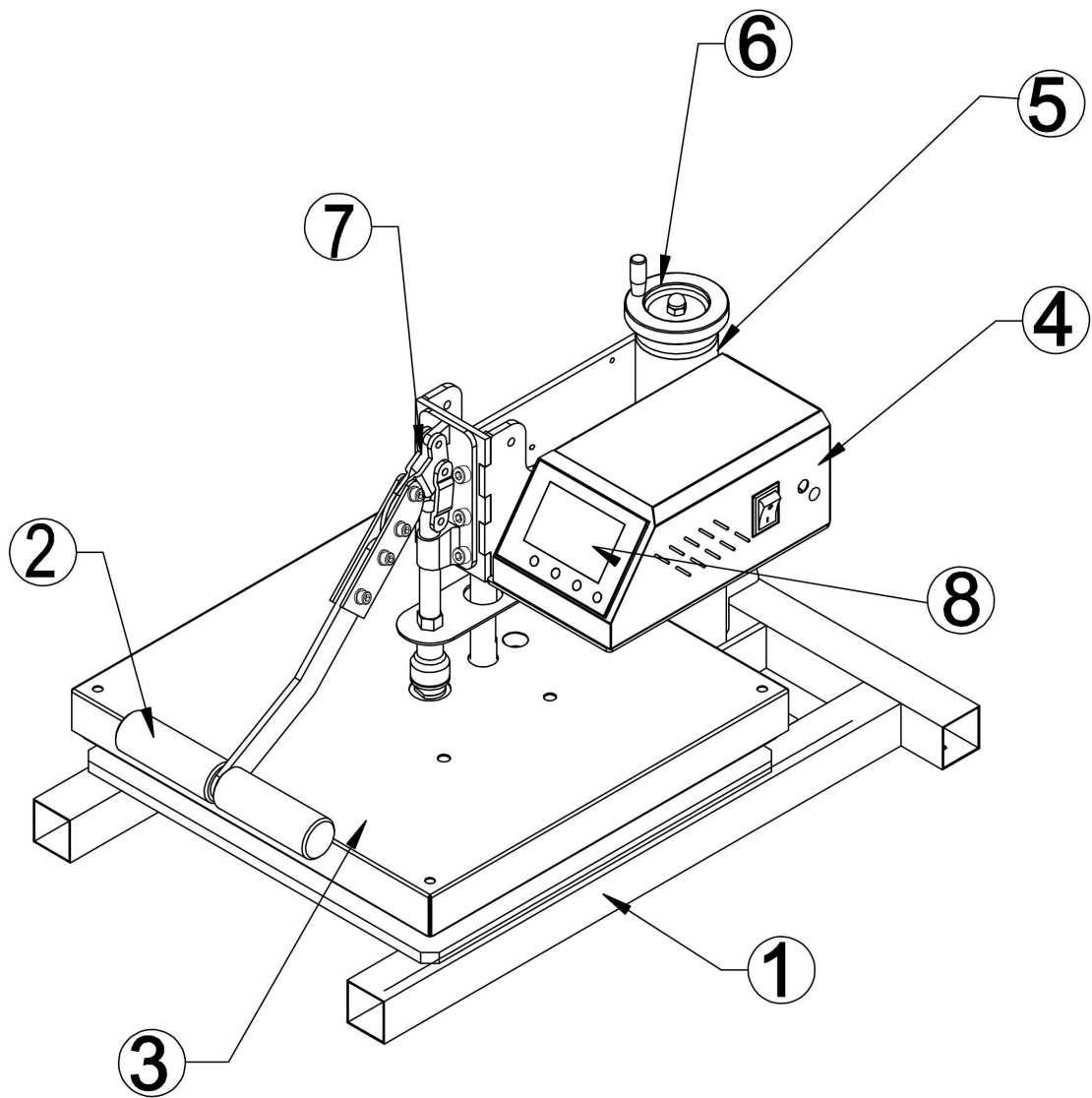

1. Frame

2. Handle

3. Heating Element

4. Computer Gauge

5. Arm

6. Pressure Adjust Knob

7. Clamp

8. GY-06 Digital Controller

The Instruction Manual of GY-06 Digital Controller

1: Plug in and turn on the machine. The controller shows its original setting like below:

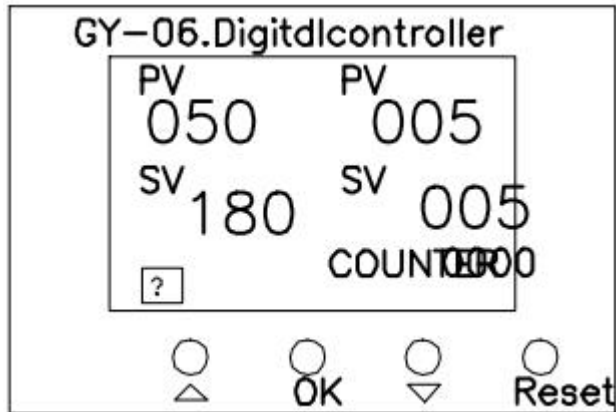

2: Click OK button and the controller will show like below:

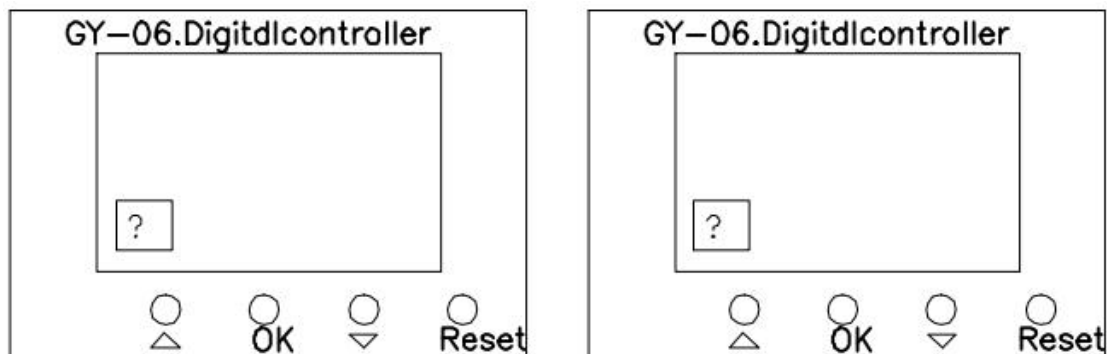

You can switch °F between °C by clicking "Up" and "Down" button

3: Click OK button again, you can start setting the temperature.

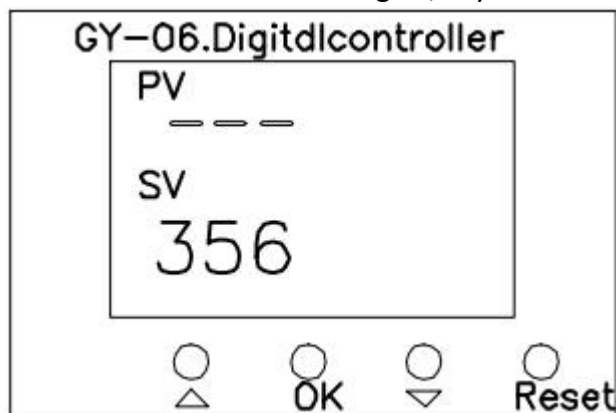

You can increase or decrease the temperature by clicking "Up" and "Down" button.
(SV: Setting Value; PV: Present Value)

4: Click OK button again, you can start setting the counting down value.

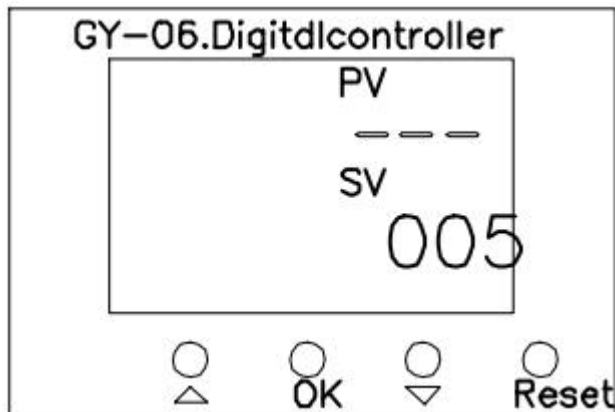

You can increase or decrease the number by clicking "Up" and "Down" button. (SV: Setting Value; PV: Present Value)

5: Click OK button again, the controller will start working.

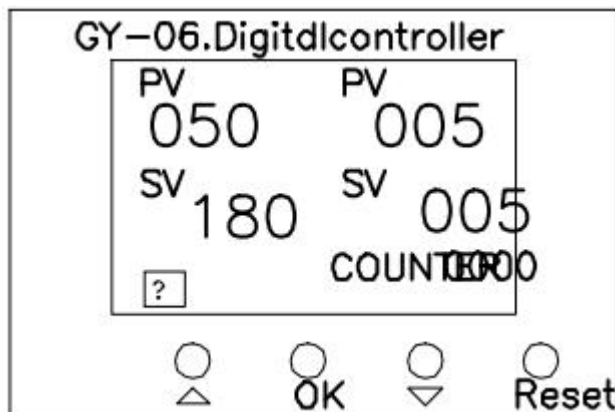

6: "COUNTER" means how many times the controller has been used. Range is 0-999. Press "Reset" button for 5 seconds it will be zero.

7: Note: When showing temperature on the controller is different from the value you have tested, press "OK" button for 5 seconds and you can adjust Temperature compensation value like below photo:

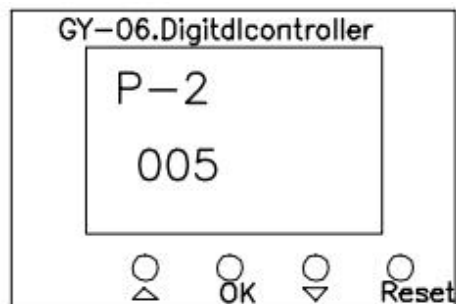
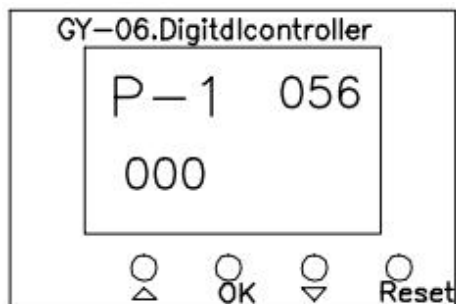

7-1: If SV is 200°C, PV is 170°C, set the value to 30.

7-2: If SV is 200°C, PV is 230°C, set the value to -30.

Maintenance

1. Please often apply some lubricating oil on the axis and guide pillar to make sure the machine can work well and prolong its life.
2. Please turn off the power switch when replacing spare parts. Please reset the value of GY-06 digital controller after the replacement, to make sure the data is accurate.
3. Please pay more attention to protect the heating element, or you will suffer a bad sublimation result.

Common Malfunction and Solutions

1. The time & temperature setting are abnormal:
Solution: Reset the time & temperature according to this manual.
2. The transfer is even but the color is not as good as the original photo:
Solution: Increase transfer time; Increase transfer temperature.
3. The sublimation image is brown or the sublimation paper is burned:
Solution: Lower the transfer temperature.
4. The transfer image is not even:
Solution: Adjust the pressure of heating element.
5. If electrical malfunction occurs, please contact the supplier as soon as possible and solve the problem under their guidance.

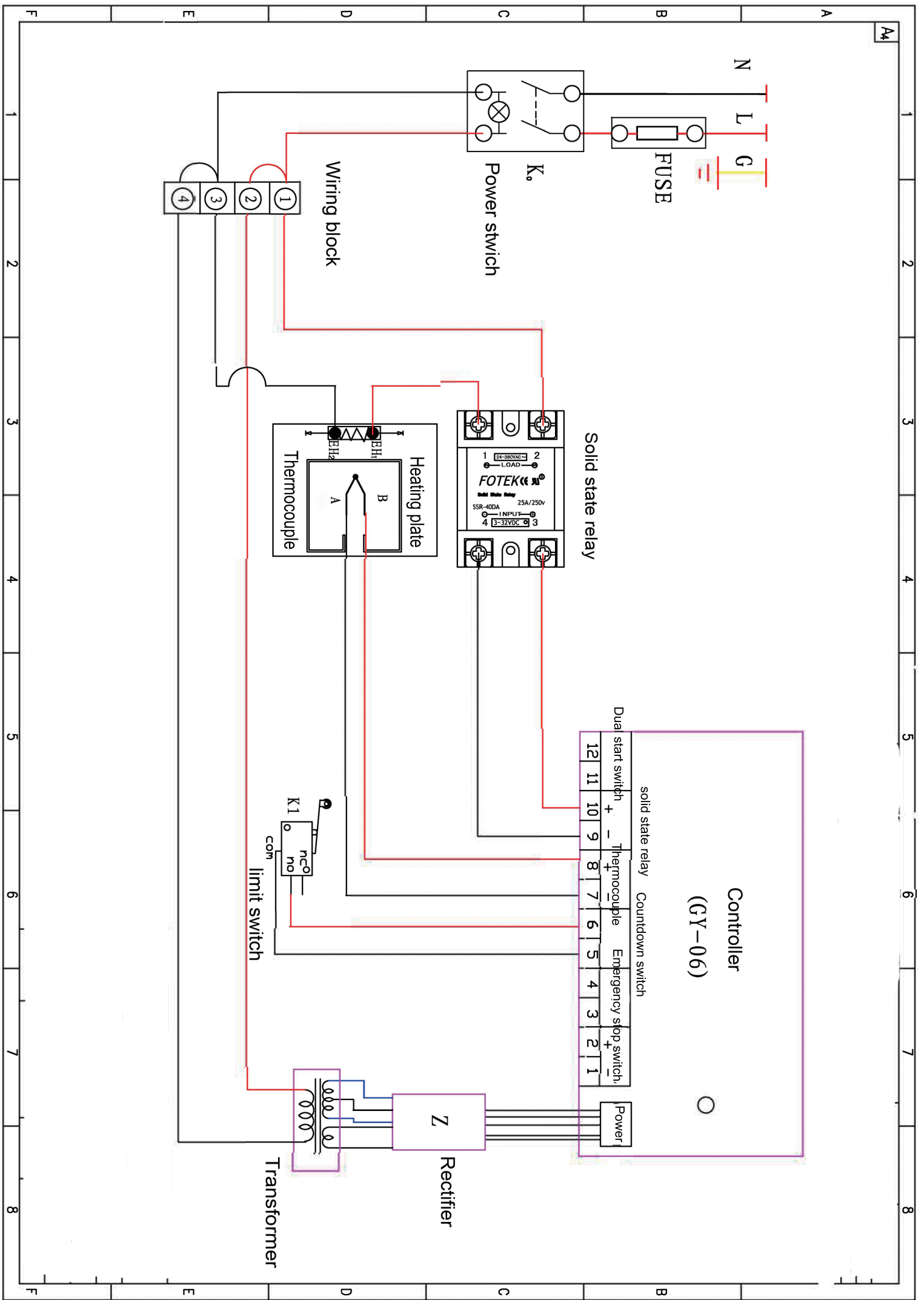

Controller
(GY-06)

Dual start switch	+	-	Thermocouple	Countdown switch	Emergency stop switch	Power
12	11	10	9	8	7	6
5	4	3	2	1		

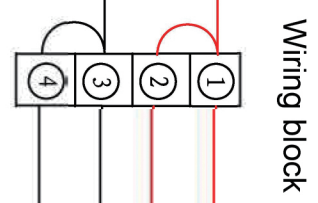
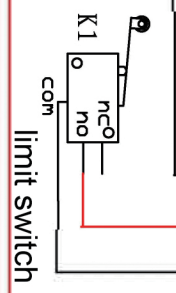
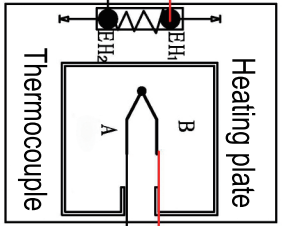
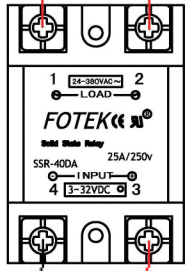

FUSE

K₀

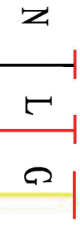
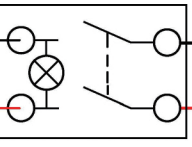

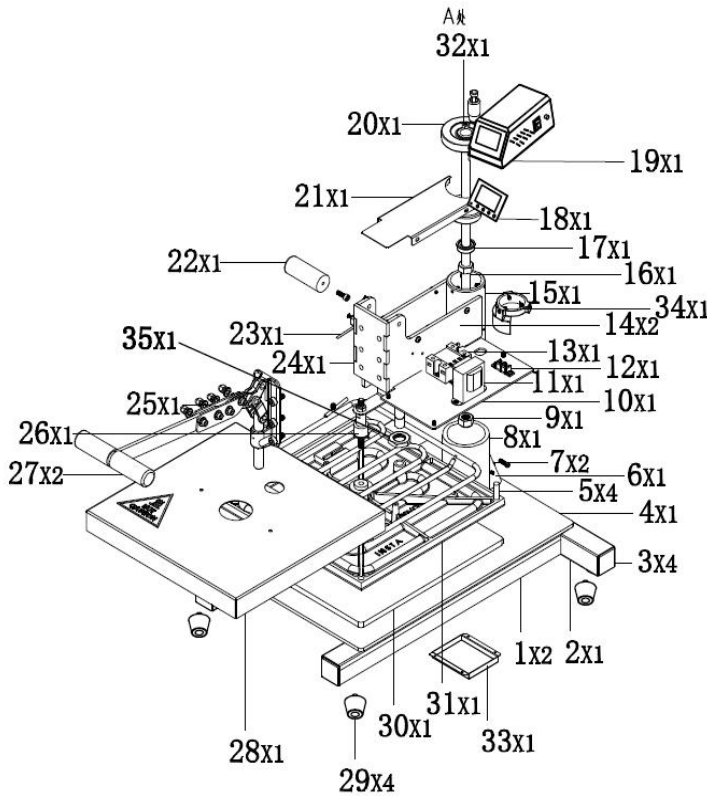

NO.	ITEM	QTY
1	Square Tube	2
2	Square Tube	1
3	Tube	4
4	Welding Plate	1
5	Positioning Shaft Of Heating Cover Plate	4
6	Stand Column	1
7	Power Cable Clip	2
8	Stand Column	1
9	Six Angle Nut	2
10	Electrical Mounting Plate	1
11	Transformer	1
12	Line Bank	1
13	Solid-State Relay	1
14	Welded Plate	2
15	Tube	1
16	Pressure Regulating Lever	1
17	Bearing	1
18	Controller	1
19	Electrical Boxes	1
20	Pressure Regulating Handwheel	1
21	The Case Cover Plate	1
22	Handle	1
23	Microswitch	1
24	Quick Clip Mounting Plate	1
25	Quick-Clamp	1
26	The Connection Of Theating Plate	1
27	Handle	2
28	Heating Plate Cover	1
29	Machine Stand	4
30	Silicone Pad	1
31	38*38Cm Heating Plate	1
32	Non-Slip Nut	1
33	Base Cover	1
34	Calibration Ring	1
35	Lock Nut	1